

## CANOPIES

BF-600-V-Bank

### Features

Construction facilitates the insertion of double row filters that extend from the left to the right across the canopy length to ensure an even flow of air over the entire length. Seams are continuous throughout the length and width (there are no upstanding or protruding joints). All the joints are welded together, ground and polished to the original material texture. The use of bolts, nuts and rivets are avoided. All sharp edges and burrs are cleaned and polished to ensure safety of cleaning personnel. Internal crevices between canopy joints are filled with a polyurethane or silicone sealer.

### Filters

Impingement baffle type filters are manufactured from 0.7mm grade 430 st/steel. Filters are easily fitted without the use of tools. They slide into the position provided by the filter housing frame. When fitted in position the filter also acts as a fire barrier. The filters are self draining and do not block with grease when used for prolonged periods without cleaning intervals.



Slope or box versions are available

### Application

Extracts steam produced by present day catering equipment. Especially used over island type cooking equipment.

### Drawings

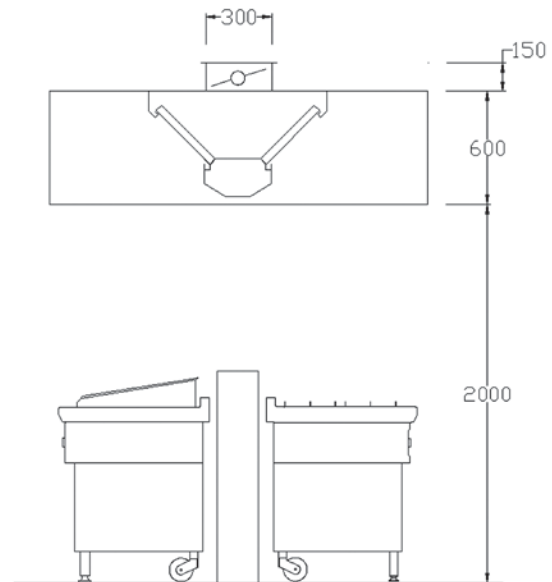
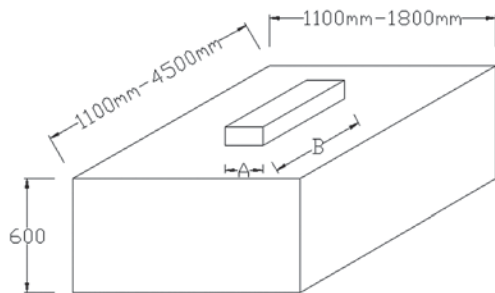

### Specifications

LENGTH	FIRE DAMPER A X B	AIR VOLUME m <sup>3</sup> /s
1100-1300	300 x 500	0.91 - 1.07
1500-1700	300 x 600	1.24 - 1.40
1900-2100	300 x 700	1.57 - 1.73
2300-2500	300 x 800	1.90 - 2.06

LENGTH	FIRE DAMPER A X B	AIR VOLUME m <sup>3</sup> /s
2700-2900	300 X 900	2.23 - 2.39
3100-3300	300 X 1000	2.56 - 2.72
3500-3700	300 X 1100	2.89 - 3.05
3900-4100	300 X 1200	3.22 - 3.38